

3. Air Cleaner Case

A: REMOVAL

1) Disconnect the ground cable from battery.

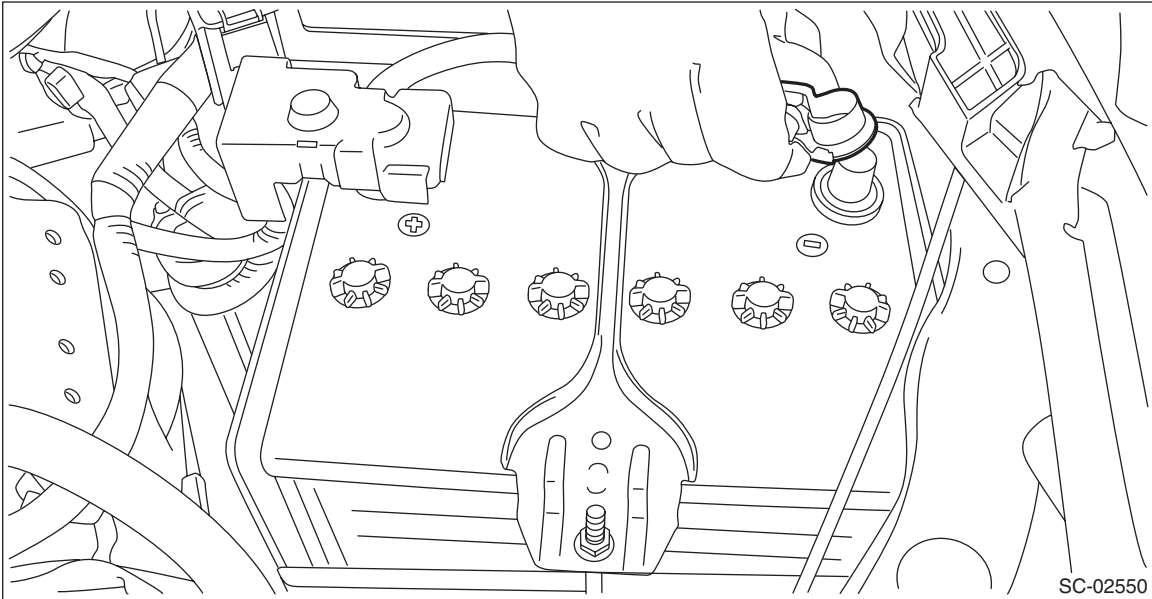

2) Remove the air intake duct. <Ref. to IN(H4DO(w/o HEV))-13, REMOVAL, Air Intake Duct.>

3) Disconnect the connector (A) from the mass air flow and intake air temperature sensor, and remove the clip (B).

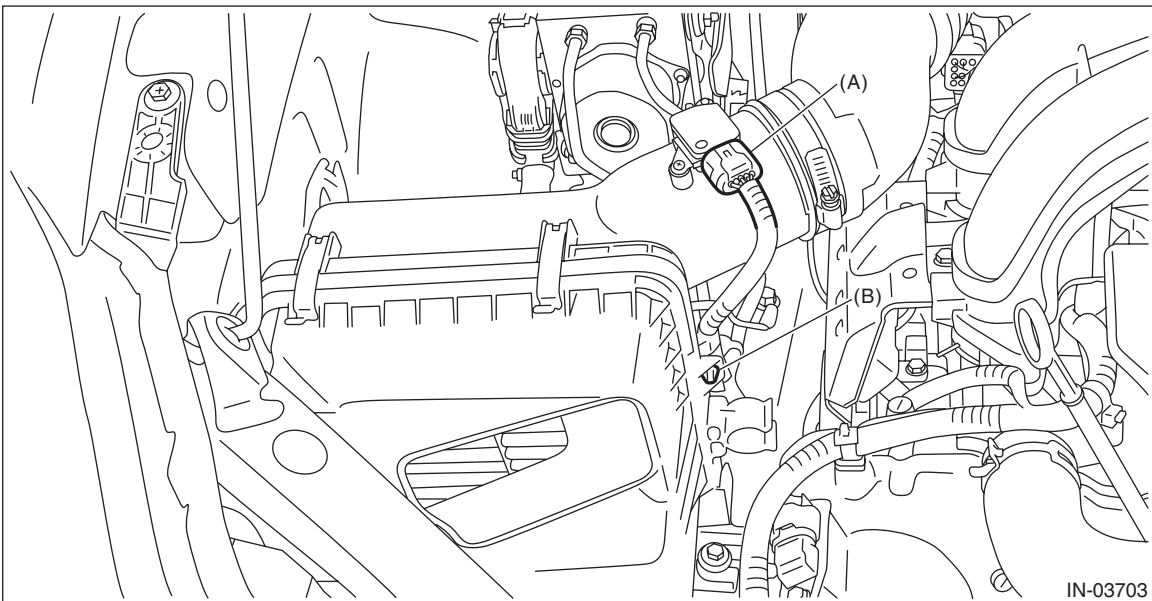

Air Cleaner Case

INTAKE (INDUCTION)

4) Loosen the clamp (A) which secures the air intake boot to the air cleaner case (rear), and then remove the clip (B) from the air cleaner case (front).

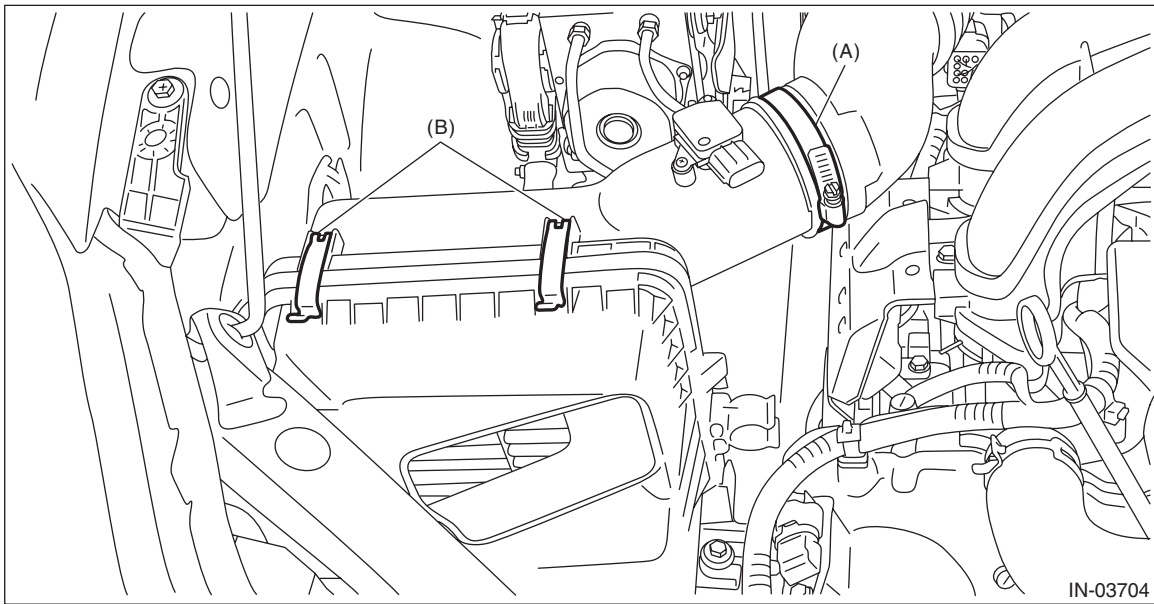

5) Remove the air cleaner case (rear) and air cleaner element.

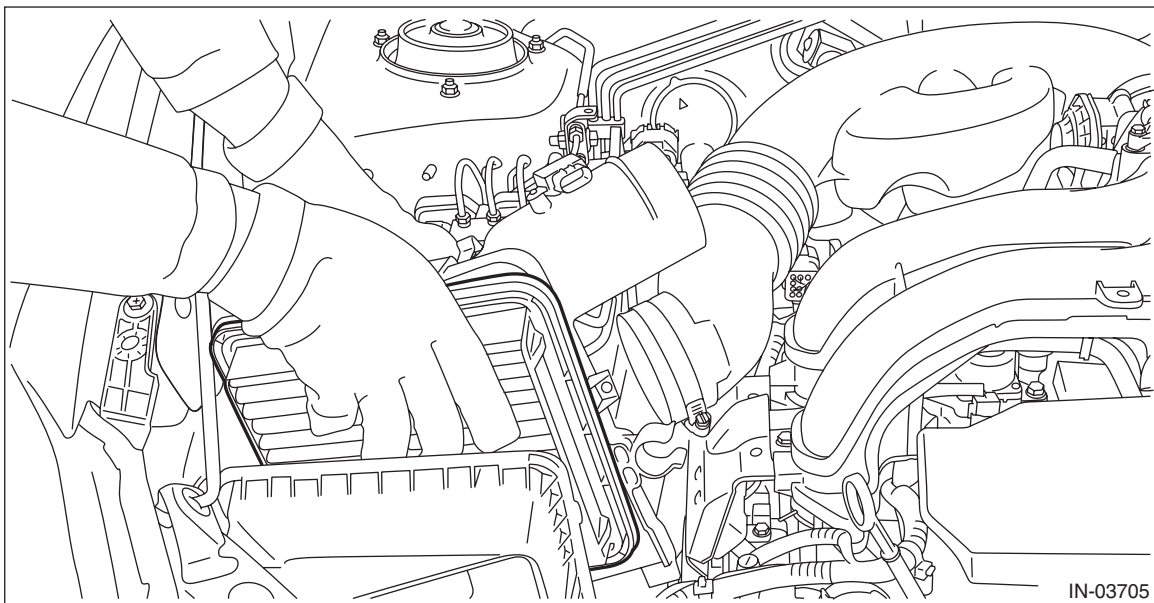

- 6) Remove the bolt (A) and nut (B) which secure the air cleaner case (front) to the body.

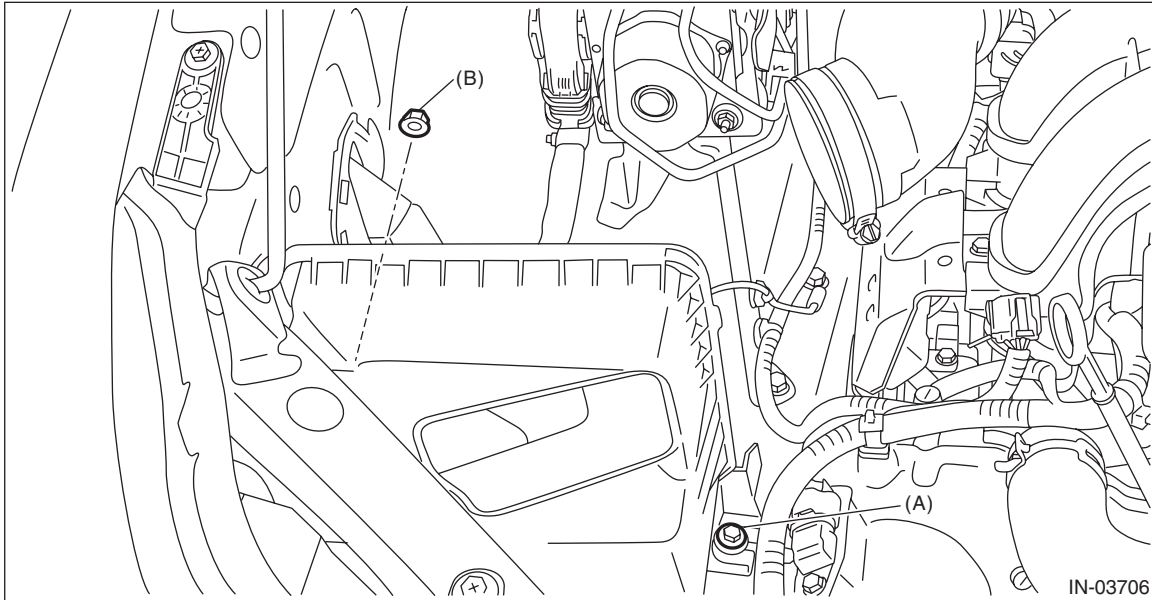

- 7) Remove the air cleaner case (front).

B: INSTALLATION

- 1) Install the bolt (A) and nut (B) which secure the air cleaner case (front) to the body.

Tightening torque:

Bolt (A)

6 N·m (0.6 kgf-m, 4.4 ft-lb)

Nut (B)

7.5 N·m (0.8 kgf-m, 5.5 ft-lb)

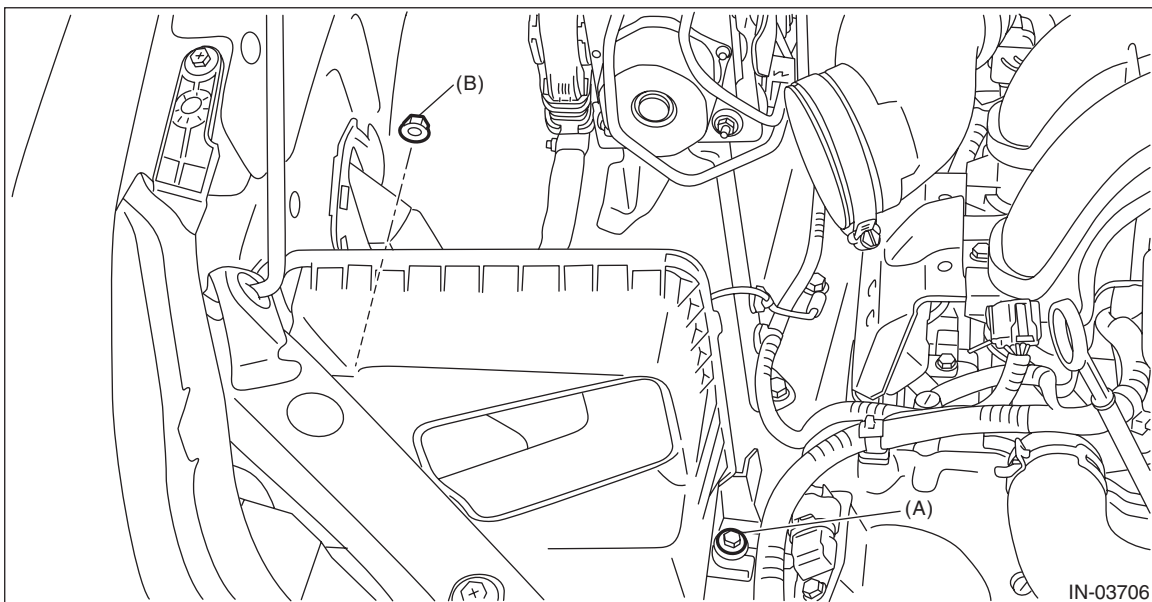

Air Cleaner Case

INTAKE (INDUCTION)

2) Install the air cleaner case (rear) and air cleaner element.

NOTE:

When installing the air cleaner case (rear), align the protrusion of the air cleaner case (rear) to the hole on the air cleaner case (front) to install.

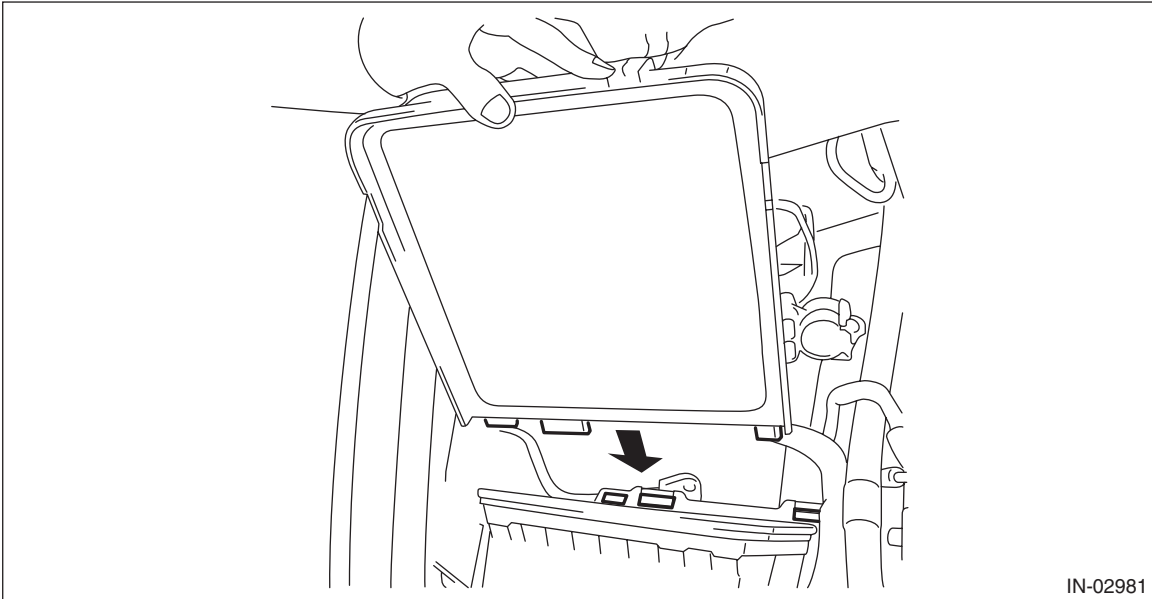

3) Install the clips (B) to the air cleaner case (front), then tighten the clamp (A) that secures the air intake boot to the air cleaner case (rear).

Tightening torque:

Clamp (A)

3 N·m (0.3 kgf-m, 2.2 ft-lb)

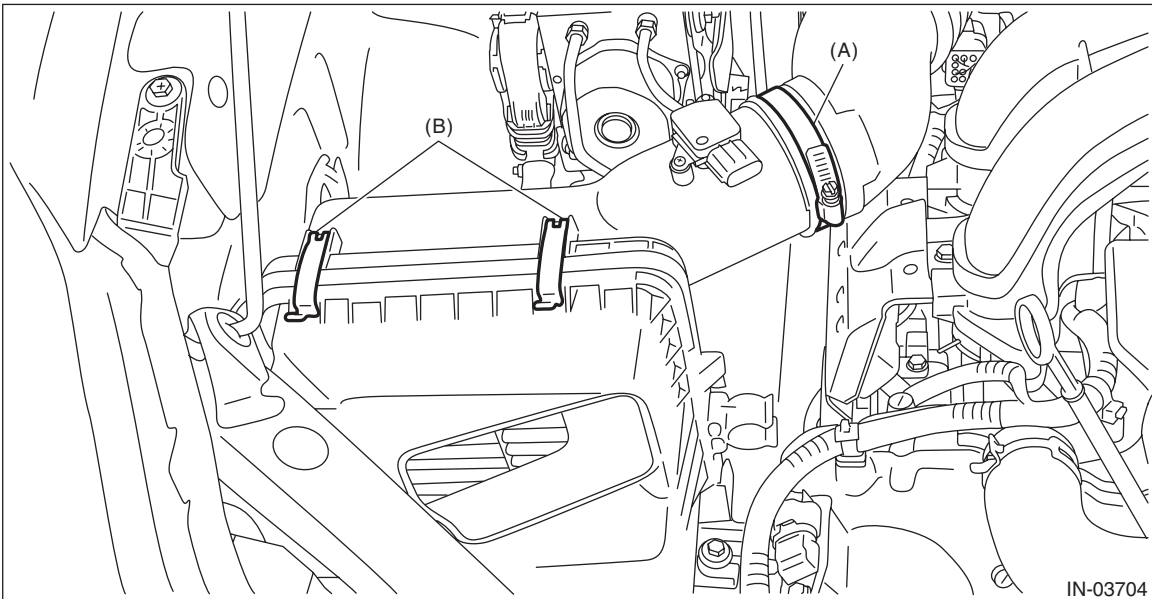

- 4) Connect the connector (A) to the mass air flow and intake air temperature sensor and secure the harness with clip (B).

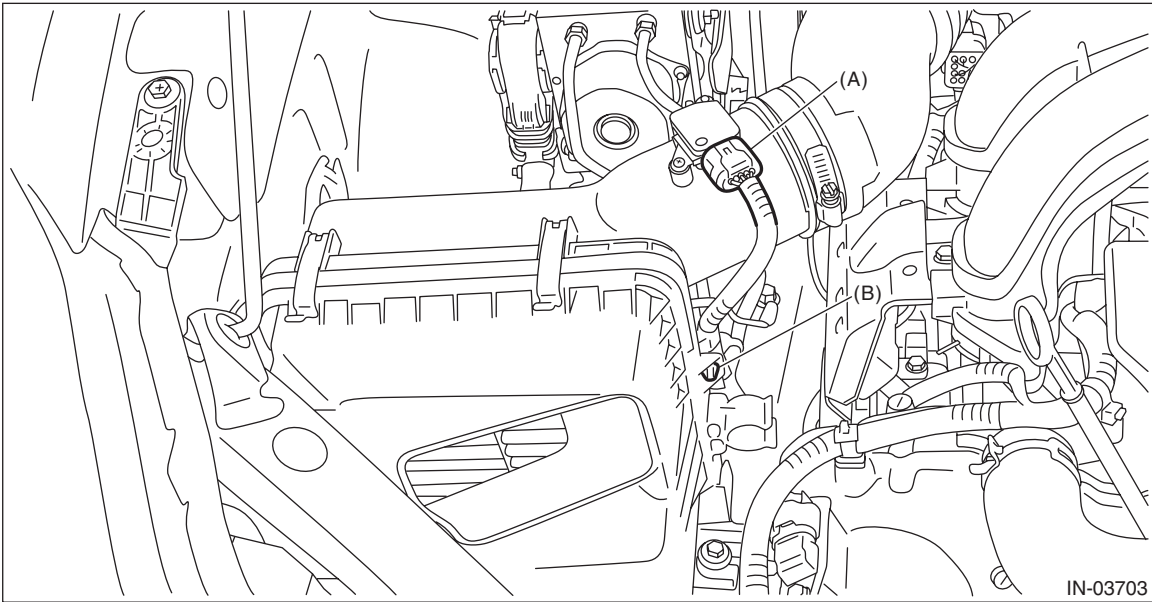

- 5) Install the air intake duct. <Ref. to IN(H4DO(w/o HEV))-13, INSTALLATION, Air Intake Duct.>
6) Connect the battery ground terminal.

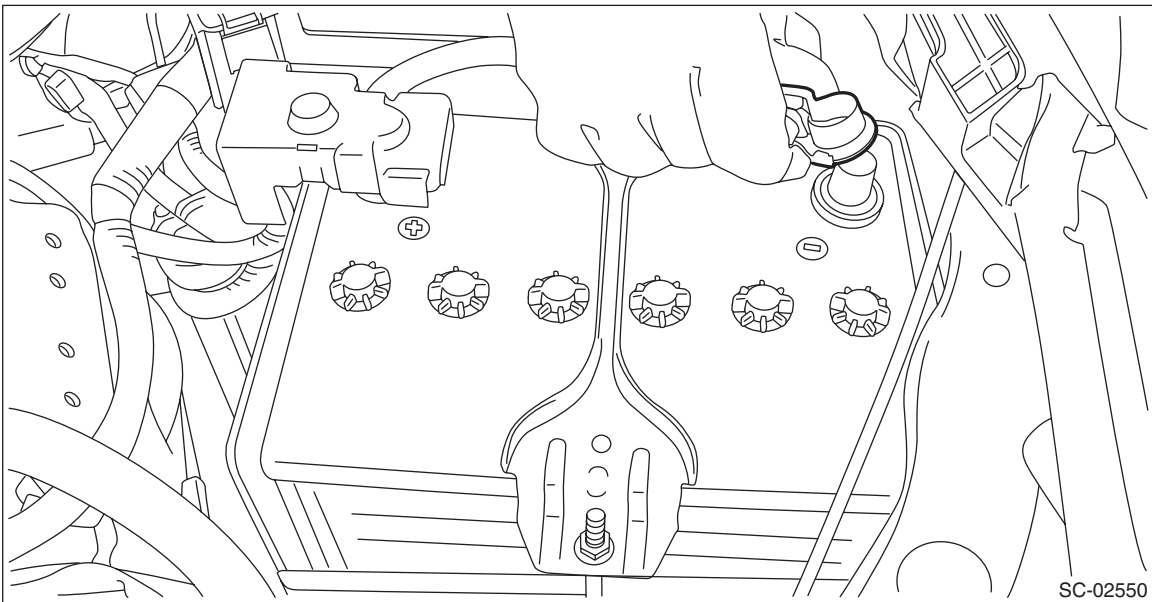

C: INSPECTION

- 1) Check that the air cleaner case has no deformation, cracks or other damages.
- 2) Check that the air intake boot has no cracks, damage or loose part.